

# VORTEX™2

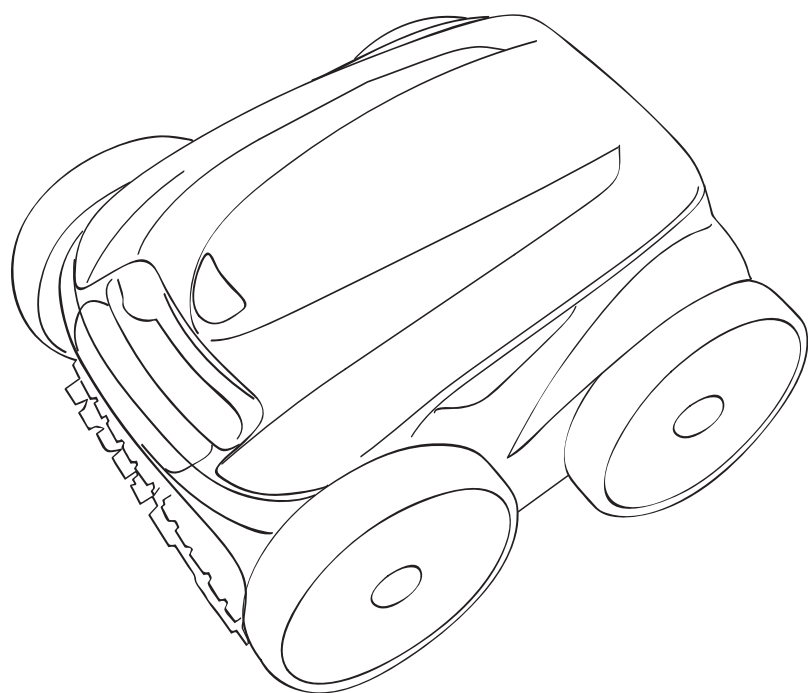



Instructions for installation and use  
English

EN

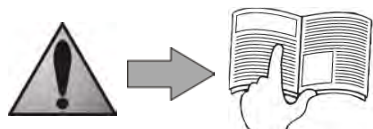
More languages on:  
[www.zodiac-poolcare.com](http://www.zodiac-poolcare.com)



- Read this manual carefully before installing, maintaining or repairing this appliance!
- The symbol  indicates important information that must be taken into consideration in order to avoid risk of harm to persons or damage to the appliance.
- The symbol  indicates useful information.
- Exclusive use: Pool water cleaning (must not be used for any other purpose).



## Warning

- It is important that this appliance be handled by skilled and apt persons (physically and mentally) having received the instructions for use beforehand (through reading these instructions). All persons not meeting these criteria must not approach the appliance in order to avoid exposure to dangerous parts.
- If the appliance suffers a malfunction: do not try to repair the appliance yourself, contact your installer.
- Only connect the control box to a power outlet protected by a 30 mA maximum ground fault circuit breaker (if in doubt contact a qualified electrician).
- Make sure that the power socket is permanently and easily accessible and sheltered from rain and splashing water.
- The control box must not be installed in a floodable area.
- The control box must be stored in a dry place that is sheltered from the weather.
- Install the control box at least 3.5 meters from the pool edge and avoid exposing it to direct sunlight. Preferably in a cool, ventilated and shaded area.
- Do not allow bathing when the cleaner is in the pool. If the control box falls into the water it is imperative that you remove the power supply before retrieving it.
- In order to avoid risks of electrocution never open the electronic control box. Contact a qualified technician.
- Never attempt to repair the power supply cable. Contact your reseller to replace it with an original part to avoid any hazards.
- Disconnect the power supply cable before any cleaning, maintenance or service operations and after each use.
- The cleaner must operate in pool water having the following characteristics: Chlorine < 3 mg/l, pH between 6.8 and 7.6, temperature between 15°C and 35°C.
- Do not operate the cleaner out of the water.
- Incorrect installation or use may cause serious damage to property or serious injuries (possibly causing death).
- Keep the appliance out of the reach of children.

### WARNING ON THE USE OF THIS CLEANER IN A POOL WITH A VINYL SURFACE

The surface of certain vinyl patterned surfaces can wear rapidly and the patterns disappear on contact from objects such as cleaning brushes, toys, inflatable buoys, chlorine distributors and automatic pool cleaners. The decoration on some vinyl surfaces can be scratched or worn by basic friction such as through the use of a pool brush. The colours of certain patterns can also be erased during use or when in contact with objects in the pool. The erased patterns, wear or scratching of vinyl surfaces are not the liability of Zodiac® and are not covered by the limited warranty.

As part of the continuous improvement process our products may be modified without prior notice.

# Contents

---

1. Information before use .....	2
2. Description of the control box.....	4
3. Use .....	4
4. Maintenance.....	4
5. Troubleshooting.....	5
6. Product compliance .....	6

## 1. Information before use

---

### **1.1 Important**

Check that your appliance has not been damaged during transport (shocks, broken parts, etc.). If you find any problems don't hesitate to contact your reseller before using the cleaner.

### **1.2 Technical specifications**

Control box power supply voltage	220-240 VAC, 50 Hz
Robot power supply	30 V DC
Max absorbed power	150 W
Cable length	15 m
Cleaner size (L x W x h)	43 x 48 x 27 cm
Package size (L x W x h)	69 x 43 x 46 cm
Cleaner weight	9.5 kg
Packaged weight	14 kg
Theoretical cleaning width	270 mm
Pump flow	16 m <sup>3</sup> /hr
Cycle duration	2.5 h

### **1.3 Recommendations for use**

- The cleaner must operate in pool water having the following characteristics: Chlorine < 3 mg/l, pH between 6.8 and 7.6, temperature between 15°C and 35°C,
- Regular use of the cleaner means that your pool will always be clean and the filter less clogged,
- When the pool is dirty, especially when commissioning, remove the largest debris using a net in order to optimise cleaner performance.
- Remove any thermometers, toys and other objects that might damage the cleaner,
- Immerse the cleaner before launching a cleaning cycle,
- Do not leave the cleaner in the water permanently,
- Do not leave the control box in direct sunlight after having used the cleaner,
- Never cover the control box while the cleaner is in operation,
- If part of the pool is not properly cleaned change the place where you immerse the cleaner until you find the best spot,
- The behaviour of the robot is strongly impacted by the tangling of the cable. Please untangle the cable and lay it out in the sun so that it returns to its original shape,
- You can operate the filtering pump during a cleaning cycle, the particles placed in suspension by the cleaner will thus be filtered out. However, if the behaviour of the cleaner is influenced by the jet as the discharge nozzle level when the filtering pump is operational, we advise you to start your robot when the filtering pump is not operating.



**Do not use your cleaner during shock chlorination!**

### **1.4 Package content**

- the cleaner
- a control box
- a floating cable
- a user manual
- the warrantee booklet

### **1.5 Immersing the cleaner**



**Do not allow bathing when the cleaner is in the pool.**

- Place the cleaner vertically into the water **(1)** and move it slightly in all directions so that the air contained in the cleaner escapes **(2)**.
- It is essential that the cleaner sinks on its own and settles on the pool bottom. Spread out the required length of cable by the pool. For optimum operation we recommend that you place the caddy with the control box at the centre of the pool length **(3)**.

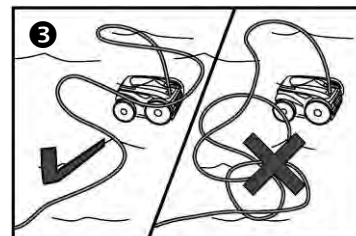
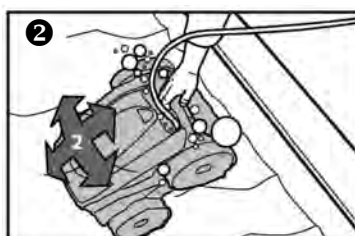
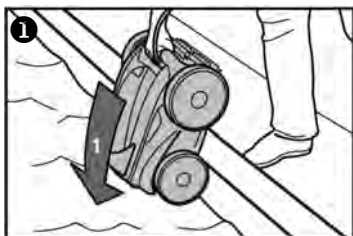

### **1.6 Electrical connection**



**Place the control box at a distance of at least 3.5 metres from the edge of the pool avoiding placing the control box in direct sunlight. Prefer a location that is clean and dry, flat and free of any object that could damage the under part of the control box.**

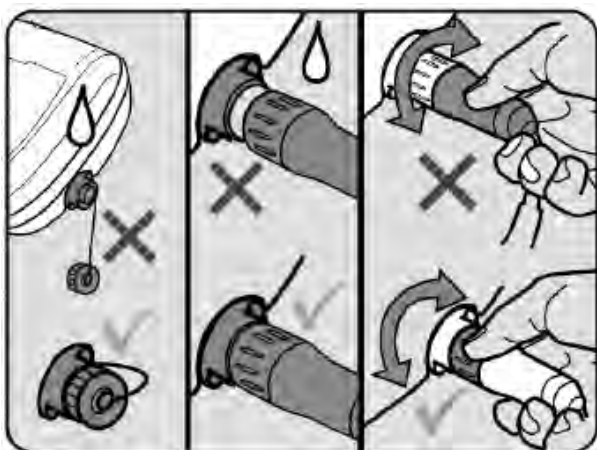

- Unscrew the protective cap.
- Connect the floating cable to the control box **(1)** and lock it into place: firmly tighten the ring by turning it clockwise **(2)**. Make sure the connector is sufficiently pushed into place. If this is not the case repeat the operation.
- Connect the mains cable. Only connect the control box to a power outlet protected by a 30 mA maximum ground fault circuit breaker **(if in doubt contact a qualified electrician)**.



**Don't forget to screw the protective cap back on if you unplug the control box power cord.**

## 2. Description of the control box

---



## 3. Use

---

### 3.1 Starting up the cleaner

- You can launch the cleaning cycle by pressing the "START / STOP" button.



The pool cleaner is so efficient that it is not necessary to run more than 3 cycles per week

### 3.2 Stopping the cleaner

- Press the "START / STOP" button on the control box.

### 3.3 Removing the cleaner from the water

When the cleaner is within hand's reach pick it up by the handle and lift it gently out of the pool so that the water it contains drains into the pool (1).



Don't pull on the cable to remove the cleaner from the pool. Use the handle.

## 4. Maintenance

---

### 4.1 Cleaning the filter



The cleaner performance can be reduced if the filter is full or dirty. Make sure you clean the filter regularly with clean water for efficient pool cleaning.

- Filter access

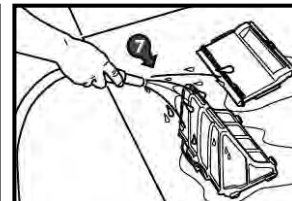
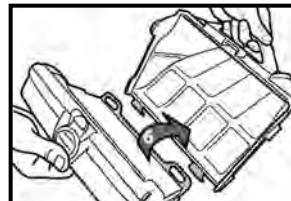
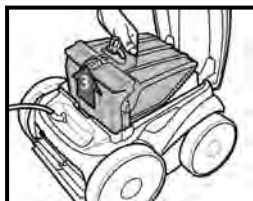
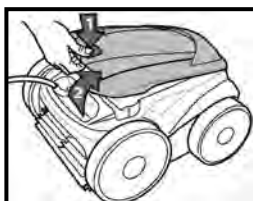

## 4.2 Replacing the brushes

- The cleaner is fitted with PVC brushes. They have wear indicators (1).
- To remove worn brushes, remove the tabs from the holes in which they are fixed.
- To fit new brushes start by fitting the side without tabs under the brush holder (2).
- Roll the brush around its support and slide the tabs into the fixing holes (3).
- Pull on the end of each tab (4) until its edge passes through the slit.
- Cut the tabs using scissors so that they are at the same level as the other blades (5).

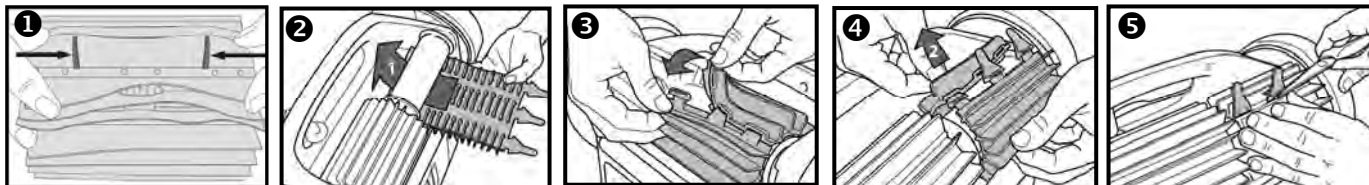

We recommend that you replace the brushes every two seasons.

## 4.3 Changing the bands

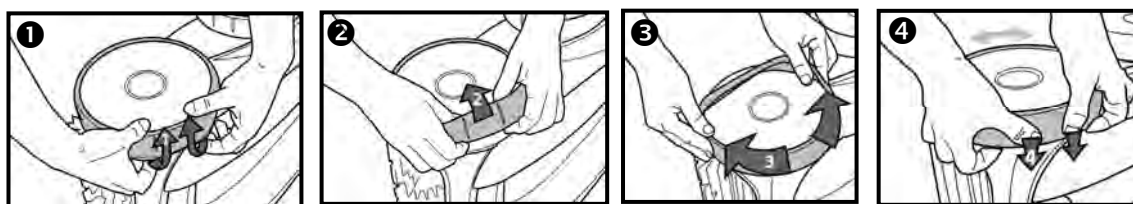

## 4.4. Maintenance of your cleaner

- The cleaner must be cleaned regularly using clean or slightly soapy water, do not use solvents such as trichloroethylene or its equivalent. Rinse the cleaner generously using clean water. Do not let your cleaner dry in the sun by the pool.
- Roll up the cable with caution when storing it so as to avoid tangling.

## 4.5 Recycling



This symbol on a new appliance means that the equipment must not be thrown away, it will be selectively collected for the purpose of reuse, recycling or creating value. If it contains substances that are potentially harmful to the environment, they will be eliminated or neutralised. Ask your reseller about how to recycle your appliance and the bodies that can do so.

## 5. Troubleshooting

### 5.1 Meaning of Control indicator Led BLINKS

- If the Led is off, the cleaner is operating normally. It is not communicating any information.
- If the Led is blinking, the cleaner is signalling that you should perform checks to improve cleaning.

Problems	Solutions
	<ul style="list-style-type: none"> <li>• Check that the cleaner is correctly connected to the control box. If necessary, unplug it and reconnect it following the appropriate procedure.</li> </ul>
	<ul style="list-style-type: none"> <li>• Check that nothing is stopping the brushes from turning correctly (sand, cable, etc.). To do this turn the wheel to the left and then right one 1/4 turn in both directions.</li> </ul>
	<ul style="list-style-type: none"> <li>• Robot operating outside the pool. Make sure you start the cleaner when it is in the water (see § 1.5).</li> <li>• Check for the presence of pebbles or hair in the fan, clean the filter.</li> </ul>

➔ If the problem continues contact your reseller.

## 5.2 Other possible situations

Problems	Solutions
The cleaner does not stay firmly on the pool bottom	This may have two causes: <ul style="list-style-type: none"> <li>• There is still air in the casing of the appliance. Repeat the immersion operations (see § 1.5).</li> <li>• the filter is full or dirty: all you have to do is clean it.</li> </ul>
The robot does not or no longer climbs the pool sides	This may have two causes: <ul style="list-style-type: none"> <li>• the filter is full or dirty: all you have to do is clean it.</li> <li>• even though the water seems clear, microscopic algae are present in your pool, they are not visible to the naked eye, and they make the sides slippery and prevent the cleaner from climbing. Carry out a shock chlorination and slightly reduce the pH.</li> <li>• <b>Do not leave the cleaner in the pool during shock treatments.</b></li> </ul>
On start-up the cleaner does not move	<ul style="list-style-type: none"> <li>• Check that the outlet to which the control box is connected is receiving a power supply.</li> <li>• Check that you have started a cleaning cycle and check that the indicators are on.</li> </ul> <b>If the problem continues contact your reseller.</b>
The cable gets tangled	<ul style="list-style-type: none"> <li>• Do not unroll the entire length of the cable into the pool.</li> <li>• Place the required length of cable in the pool and place the rest on the side of the pool.</li> </ul>
The control unit does not respond when you press the buttons	<ul style="list-style-type: none"> <li>• Unplug the cable from the mains socket, wait 10 seconds and plug it back in again.</li> </ul>

## 6. Product compliance

This appliance has been designed and built according to the following standards:

**Low voltage directive:** 2006/95/EC

**Electromagnetic compatibility directive:** 2004/108/EC

EN 55014-1: 2000 +A1:2001 +A2:2002 ; EN 55014-2: 1997 +A1:2002

EN 60335-1: 2002 + A1:2004 + A2:2006 +A11:2004 + A12:2006 ; EN 60335-2-41: 2003 + A1:2004

Relative to which it is compliant.

The product has been tested under the normal conditions of use.

Zodiac Pool Care Europe hereby declares that this product is in compliance with the essential requirements and other pertinent dispositions of the R&TTE 1999/5/EC directive

### SAFETY STANDARDS:

The cleaners are classified by the ETL as being compliant with the appropriate requirements of IEC 60335-2-41.



[www.zodiac-poolcare.com](http://www.zodiac-poolcare.com)

Pour plus de renseignements, merci de contacter votre revendeur.  
For further information, please contact your retailer.

Votre revendeur / your retailer